

785nm 10mW FP Pigtail Laser Diode

1. Features:

- Single mode FP LD;
- Monitor photodiode(Optional);
- TO-56 package;
- High reliability, long life(>2000H);
- Operating temperature range:-10~70°C;
- Telcordia GR-468 reliability test standard.

2. Applications:

- Medical;
- Automotive electronics;
- Agricultural absorption;
- Laser printing.

3. Absolute Maximum Ratings (Tc=25°C):

Parameter	Symbol	Ratings	Unit
LD Reverse voltage	V _{RLD}	2	V
PD Reverse voltage	V _{RPD}	30	V
Operating case temperature	T _{OP}	-10 ~ +70	°C
Storage Temperature	T _{ST}	-40 ~ +85	°C
Lead soldering(Temperature)/(Time)	-	260/10	°C/Sec

4. Optical-Electro Characteristics:

Parameter	Symbol	Test Condition	Min	Typ.	Max	Unit
Center wavelength	λ_C	P _{OP} = P _F	780	790	800	nm
Optical output power	P _F	I _F = 70mA	10	-	-	mW
Threshold current	I _{TH}	CW	-	30	45	mA
Operating voltage	V _F	CW	-	1.9	2.2	V
Operating current	I _F	CW	-	70	120	mA
Slope efficiency	SE	CW	1	1.1	1.2	W/A
Monitor PD	I _M	-	-	0.2	0.3	mA
Fiber type	-	-	780HP			

5. Package Drawing&PIN-OUT Definition(Unit:mm):

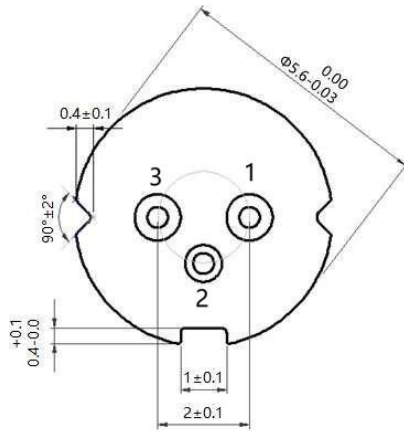
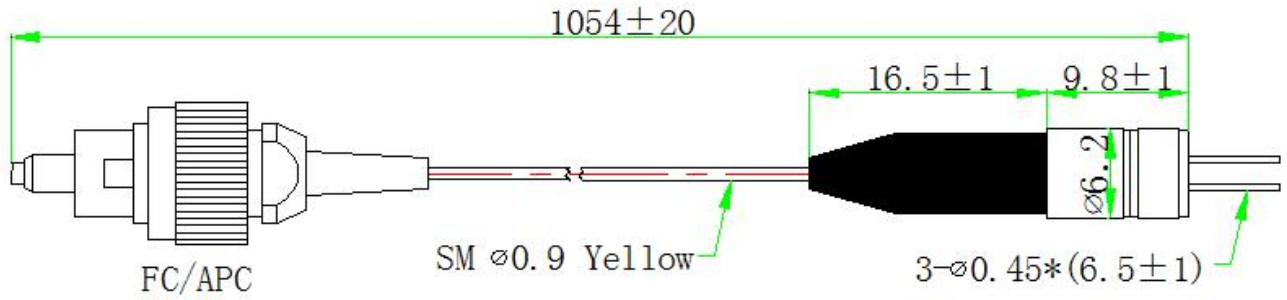

Bottom view

PIN No.	Symbol
1	LD Cathode
2	LD Anode/PD Cathode
3	PD Anode

6. Odering Information

BLD-F78510D-FA

BLD	-X	XX	XX	X	-XX
LD	Chip type	Wavelength	Output power	PIN-OUT	Connector
Laser diode	F: FP	785: 785nm	10: 10mW Other	D: Type D	FA: FC/APC